

LONGUEVILLE AGED CARE DEVELOPMENT

16 NORTHWOOD ROAD, NORTHWOOD

CIVIL ENGINEERING DA PACKAGE

DRAWING INDEX	
DRAWING No.	DESCRIPTION
DAC1.01	COVER SHEET AND DRAWING INDEX
DAC1.02	NOTES, LEGEND, AND TYPICAL DETAILS
DAC2.01	GENERAL ARRANGEMENT PLAN
DAC2.11	CATCHMENT PLAN
DAC2.21	OSD SECTION AND DETAILS
DAC7.01	SOIL EROSION AND SEDIMENT CONTROL PLAN
DAC7.11	SOIL EROSION AND SEDIMENT CONTROL NOTES AND DETAILS
DAC8.01	SEDIMENT BASIN CALCULATIONS



**DIAL BEFORE
YOU DIG**
www.1100.com.au

IMPORTANT: THE CONTRACTOR IS
TO MAINTAIN A CURRENT SET OF
"DIAL BEFORE YOU DIG" DRAWINGS
ON SITE AT ALL TIMES.



LOCALITY PLAN
NOT TO SCALE

© COPYRIGHT of this design and plan is the property of ACOR Consultants Pty Ltd. ACN 079 306 246 ABN 40 079 306 246, all rights reserved. It must not be used, modified, reproduced or copied wholly or in part without written permission from ACOR Consultants Pty Ltd.

This drawing has been assigned an electronic code that signifies the drawing has been checked and approved by:

Issue	Description	Date	Drawn	Approved
C	ISSUE FOR DA	12.08.20	KBM	TF
B	ISSUE FOR DA	10.08.20	DV	DV
A	ISSUE FOR DA	07.08.20	DV	DV

10m at full size

20m

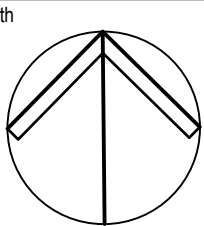

Client
PATHWAYS PROPERTY GROUP

40 CHANDOS STREET
ST LEONARDS, NSW, 2065
PHONE : 1800 825 586

Architect
MORRISON DESIGN PARTNERSHIP ARCHITECTS

302/69 CHRISSTIE STREET
ST LEONARDS, NSW, 2065
PHONE : 9966 5566



ENGINEERS | MANAGERS | INFRASTRUCTURE PLANNERS | DEVELOPMENT CONSULTANTS

ACOR Consultants Pty Ltd
Suite 2, Level 1, 33 Herbert Street
St Leonards NSW 2065
T +61 2 9438 5098



Project
LONGUEVILLE AGED CARE DEVELOPMENT

16 NORTHWOOD ROAD
NORTHWOOD, NSW, 2066

Drawing Title
COVER SHEET AND DRAWING INDEX

Drawn	Date	Scale	A1	Q.A. Check	Date
DV	AUG 20	NTS	-	-	-
Designed	Project No.	Dwg. No.	Issue		
DV	NSW200613	DAC1.01	C		

DRAWING UNDER REVISION

NOT FOR CONSTRUCTION

S:\2020\200613\Longueville Aged Care Development\200613_LDAC1.01.dwg
Aug 20, 2020 - 1:53pm

GENERAL NOTES	
1.	ALL WORK TO BE IN ACCORDANCE WITH BLACKTOWN CITY COUNCIL STANDARD DRAWINGS AND SPECIFICATIONS, AND TO THE REQUIREMENTS OF COUNCIL ENGINEERS.
2.	A SURVEY OF THE SITE HAS BEEN UNDERTAKEN BY LAND PARTNERS BUILT ENVIRONMENTAL CONSULTANTS AS RECEIVED BY ACOR CONSULTANTS PTY LTD' ON 20.04.2020. ALL LEVELS TO A.H.D. DRAWINGS SHOW DETAILS AT THE TIME OF SURVEY
3.	ALL RUBBISH, DEBRIS, UNDERGROWTH, FENCES & TREES NOTED ON THE PLAN WITHIN THE LIMIT OF WORKS ARE TO BE REMOVED FROM SITE AREA TO THE SATISFACTION OF COUNCIL OR THE SUPERINTENDENT
4.	NO DISTURBANCE TO THE SITE SHALL BE PERMITTED OTHER THAN IN THE IMMEDIATE AREA OF THE WORKS AND NO MATERIAL SHALL BE REMOVED FROM SITE WITHOUT COUNCIL APPROVAL
5.	NO WORK WITHIN ADJOINING PROPERTIES TO BE UNDERTAKEN WITHOUT WRITTEN PERMISSION FROM THE OWNERS OR RESPONSIBLE AUTHORITY
6.	THE CONTRACTOR SHALL OBTAIN LEVELS FROM ESTABLISHED BENCHMARKS ONLY
7.	THE LOCATION OF RECOVERY MARKS AND BENCH MARKS SHOULD BE VERIFIED AND CONFIRMED BY THE CONTRACTOR AND ANY DISCREPANCIES SHOULD BE CLARIFIED IN WRITING WITH THE SURVEYOR PRIOR TO THE COMMENCEMENT OF WORK
8.	THE CONTRACTOR SHALL ERECT A POLLUTION WARNING SIGN AT THE ENTRANCE TO THE SUBDIVISION OR PROPOSED DEVELOPMENT
9.	SERVICE CONDUITS SHALL BE PLACED AS DIRECTED BY ENDEAVOUR ENERGY, NBN / TELSTRA, AND AS REQUIRED BY THE RELEVANT SERVICE AUTHORITY AND AS PER SERVICE AUTHORITY APPROVED PLANS
10.	STREET SIGNS REQUIRED WHERE SHOWN. STREET SIGNS TO COUNCIL STANDARD SHALL BE INSTALLED BY THE CONTRACTOR.
11.	SIGNPOSTING AND LINEMARKING TO CONFORM WITH AS1742.2 & AS1743. RAISED RETRO-REFLECTIVE PAVEMENT MARKERS TO CONFORM WITH AS1906 & AS1743.
12.	KERB RAMP CROSSINGS TO BE PROVIDED WHERE SHOWN ON PLAN AND CONSTRUCTED AS DETAILED AND TO COUNCIL STANDARDS
13.	NO TREES ARE TO BE REMOVED OR LOPPED OTHER THAN THOSE SHOWN AND THOSE IN ROAD RESERVES, WITHOUT COUNCILS WRITTEN PERMISSION. A TREE INSPECTION WITH COUNCIL SHALL BE ARRANGED ONCE LOTS HAVE BEEN PEGGED.
14.	ALL NEW WORKS ARE TO MAKE SMOOTH JUNCTIONS WITH ALL EXISTING CONDITIONS. AC JOINTS TO BE SAW CUT AT CONNECTION TO EXISTING PAVEMENT. THE CONTRACTOR IS TO MAKE ALL DUE ALLOWANCES FOR WORKS DURING CONSTRUCTION.
15.	SUBSOIL DRAINAGE TO BE PROVIDED BEHIND KERBING AS PER APPROVED PLANS AND AS DIRECTED BY COUNCIL OR THE CERTIFIER DURING CONSTRUCTION.
16.	THE THICKNESS OF ROAD PAVEMENTS SHALL BE CONFIRMED BY THE CONTRACTOR UPON COMPLETION OF SUBGRADE TESTING UNDERTAKEN BY THE CONTRACTOR.
17.	SERVICES TO EXISTING DEVELOPMENTS ARE TO BE MAINTAINED AT ALL TIMES.
18.	PROPOSED SERVICES CROSSING EXISTING ROADS SHALL BE THRUST BORED UNDER THE ROAD SO AS NOT TO DAMAGE EXISTING SURFACES.
19.	CONTRACTOR IS TO VERIFY THE LOCATION OF ALL EXISTING SERVICES WITH EACH RELEVANT AUTHORITY PRIOR TO COMMENCEMENT OF CONSTRUCTION. ANY DAMAGE TO SERVICES SHALL BE REPAIRED BY THE CONTRACTOR OR THE RELEVANT AUTHORITY AT THE CONTRACTOR'S EXPENSE. SERVICES SHOWN ON THESE PLANS ARE ONLY THOSE EVIDENT AT THE TIME OF SURVEY. ANY UTILITIES ADJUSTMENTS REQUIRED TO BE AT THE CONTRACTORS EXPENSE.
20.	ENSURE ADEQUATE TRENCH FOUNDATION AND BEDDING COMPACTION SPECIFICALLY ADJACENT TO DRAINAGE STRUCTURES AND PROTECTION TO PIPES FROM CONSTRUCTION TRAFFIC. CRACKED STORMWATER PIPES WILL NOT BE ACCEPTED.
21.	PROVIDE GALVANISED STEEL KERB OUTLETS PLACED IN KERB ON LOW SIDE OF LOTS, 500mm FROM BOUNDARY OR WHERE SHOWN. PROVIDE SUITABLE ADAPTOR TO ALLOW CONNECTION OF 90mm DIA. S.W.PIPE IN ACCORDANCE WITH COUNCIL STANDARDS
22.	NO MATERIALS TO BE STOCKPILED ON FUTURE ALLOTMENTS WITHOUT APPROVAL IN WRITING FROM THE CLIENTS REPRESENTATIVE.
23.	MINIMUM SITE DISTURBANCE AND MAXIMUM VEGETATION AND TREE PRESERVATION TO BE MAINTAINED AT ALL TIMES.
24.	EROSION AND SILT PROTECTION MEASURES ARE TO BE MAINTAINED AT ALL TIMES AND THE LENGTH OF TRENCH OPENINGS MINIMISED.
25.	THE CONTRACTORS ITP SHALL ALLOW FOR A HOLD POINT TO ALLOW CHECK LEVELS AND PROOF ROLL PRIOR TO PLACEMENT OF <ul style="list-style-type: none">SUB BASE COURSEBASE COURSE MATERIALWEARING COURSE MATERIAL, PRIME COAT TWO WEEKS PRIOR TO AC SEAL, THICKNESS OF AC SEAL AS SPECIFIED
26.	ALL PIPES TO BE SOCKET/SPIGOT RUBBER RING JOINT FRC PIPES CLASS '3' OR REINFORCED CONCRETE CLASS '3'. UNLESS NOTED OTHERWISE.
27.	GRATES TO COMPLY WITH COUNCIL STANDARDS, ALL GRATES TO BE CYCLE FRIENDLY GALVANISED BOLT DOWN TYPE.
28.	STEP IRONS REQUIRED IN PITS GREATER THAN 1.0m DEPTHS.
29.	THE CONTRACTOR WILL BE RESPONSIBLE FOR THE FULL QA DOCUMENTATION OF THE PROJECT TO ENSURE WORKS MEET THE RELEVANT SECTIONS OF THE CC FOR ROADS AND DRAINAGE WORKS. A COMPLETE ITP PLAN SHALL BE SUBMITTED TO THE SUPERINTENDENT FOR APPROVAL PRIOR TO WORKS COMMENCING ON SITE, COVERING ALL ASPECTS OF THE CONTRACT.

GENERAL NOTES	
30.	ALL WORKS ARE TO BE SETOUT BY A REGISTERED SURVEYOR.
31.	THE CLIENT WILL PREPARE WAE DRAWINGS AT COMPLETION TO ENSURE THE WORKS MEET THE REQUIREMENTS OF THE DESIGN.
32.	A TRAFFIC CONTROL PLAN IS TO BE SUBMITTED TO COUNCIL BY THE CONTRACTOR FOR APPROVAL PRIOR TO WORKS COMMENCING.
33.	CONTRACTOR IS TO PROVIDE A 3m LONG LENGTH OF 1000 SUBSOIL DRAINAGE LINE ON THE UPSTREAM SIDE OF DRAINAGE PITS, INCLUDING GEOFABRIC SOCK AND NOM. 20mm GRAVEL
34.	ALL DRAINAGE TRENCHES WITHIN THE ROAD RESERVE ARE TO BE BACKFILLED WITH CLEAN SHARP SAND.
35.	SUB-BASE AND BASE MATERIALS FOR ROADS MUST COMPLY WITH RMS SPECIFICATION 3051 OR THE COUNCIL'S SPECIFICATION. ALL OTHER ROAD PAVEMENT MATERIALS MUST COMPLY WITH THE RELEVANT RMS SPECIFICATION OR THE COUNCIL'S SPECIFICATION.
36.	ALL ROADS SHALL BE SURFACED WITH AN INITIAL COURSE OF 25mm THICKNESS AC10. FINAL WEARING COURSE OF 25mm THICKNESS OF AC10 WILL BE LAID BY COUNCIL AT A LATER DATE AND PAID FOR BY THE APPLICANT AS A MONETARY PAYMENT.
37.	POWER & LIGHT POLES TO HAVE A 1m X 1m ISOLATION ZONE REGARDLESS OF LOCATION.
38.	ALL INTER-ALLOTMENT PIPELINES TO HAVING RODDING EYES IMMEDIATELY DOWNSTREAM OF ALL SLOPE JUNCTIONS.
39.	CONCRETE PATHS, DRIVEWAYS, & BATTLE-AXE HANDLES TO BE BONDED PENDING COMPLETION OF SERVICES IN ACCORDANCE WITH COUNCIL REQUIREMENTS AND AS DIRECTED BY THE PRINCIPAL
40.	ALL MAJOR & NON-STANDARD STRUCTURES TO HAVE ENGINEERING CERTIFICATION.
41.	HIGH EROSION AREAS, INCLUDING BATTERS TO BE STABILISED WITHIN 7 DAYS OF COMPLETION OF WORKS AND EARLIER IF DIRECTED BY THE SUPERINTENDENT.
42.	ALL STABILISED WORKS ARE TO BE MAINTAINED UNTIL EXPIRY OF MAINTENANCE PERIOD.
43.	ALL STRABILISED WORKS ARE TO BE MAINTAINED UNTIL EXPIRY OF MAINTENANCE PERIOD. OVERFLOW PATHS TO BE FORMED AT THE TIME OF CONSTRUCTION TO SUIT DESIGN ARI
44.	VARIATIONS NEED TO BE APPROVED PRIOR TO COMMENCEMENT OF WORK. IF IN DOUBT, CONTACT ACOR CONSULTANTS

EARTHWORKS NOTES	
1.	EARTHWORKS TO BE CARRIED OUT TO THE SATISFACTION OF COUNCIL'S AND RELEVANT AUSTRALIAN STANDARD AND GEOTECHNICAL ENGINEER. UNSOUND MATERIALS ARE TO BE REMOVED FROM ROADS AND LOTS AND TESTED PRIOR TO FILLING. THE CONTRACTOR IS TO PROVIDE PLANS OF TEST LOCATIONS AND TEST CERTIFICATES AS PER THE SPECIFICATION WHERE REQUIRED. THE CONTRACTOR MUST ENSURE COUNCIL APPROVAL OF MATERIALS, PRIOR TO DELIVERY TO SITE.
2.	TOPSOIL FROM SITE FILLING AND REGRADING AREAS TO BE STRIPPED, STOCKPILED AND RESPREAD AS SHOWN ON PLAN. EXCESS MATERIAL TO BE CARTED OFFSITE TO APPROVED LOCATION. ALL SITE FILLING TO BE COMPACTED IN ACCORDANCE WITH AS3798 TO A MIN. OF 98% SMDD AT ±2% OF O.M.C. A GEOTECHNICAL CERTIFICATE FROM A N.A.T.A REGISTERED LABORATORY IS TO BE SUPPLIED BY CONTRACTOR.
3.	WHERE THE SLOPE OF THE NATURAL SURFACE EXCEEDS ONE IN FOUR (1:4) BENCHES ARE TO BE CUT TO PREVENT SLIPPING OF THE PLACED FILL MATERIAL AS REQUIRED BY THE DEVELOPER'S GEOTECHNICAL ENGINEER TO STANDARD PRACTICE.
4.	ALL BATTERS ARE TO SCARIFIED TO ASSIST WITH ADHESION OF TOP SOIL TO BATTER FACE.
5.	PROVIDE MIN. 50mm - 75mm TOPSOIL WITH COUCH GRASS TURF ON ALL FOOTPATHS. ALL BARE AREAS OTHER THAN FOOTPATHS TO BE SOWN WITH SEED, FERTILISED AND HAY MULCHED TO COUNCIL'S SPECIFICATION. GRASS / TURF TO BE MAINTAINED BY CONTRACTOR AT ALL TIMES INCLUDING PERIODS OF INSUFFICIENT RAIN.
6.	THE CONTROL TESTING OF EARTHWORKS SHALL BE IN ACCORDANCE WITH THE GUIDELINES IN AUSTRALIAN STANDARD 3798-1990. WHERE IT IS PROPOSED TO USED TEST METHOD AS1289 EB.1 OR AS1289 EB2 TO DETERMINE THE FIELD DENSITY, A SAND REPLACEMENT METHOD SHALL BE USED TO CONFIRM THE RESULTS AS DIRECTED BY COUNCIL.
7.	THE CONTRACTOR SHALL CONTROL SEDIMENTATION, EROSION AND POLLUTION DURING CONSTRUCTION IN ACCORDANCE WITH THE REQUIREMENTS OF COUNCIL AND APPROVED PLANS.
8.	A 1.2 METER WIDE, CONTINUOUS STRIP OF COUCH GRASS SHALL BE PLACED BEHIND THE BACK OF ALL KERBS AND PERIMETER OF ALL INLET PITS IMMEDIATELY AFTER THE COMPLETION OF THE FOOTPATH GRADING AND CONSTRUCTION OF PITS RESPECTIVELY, MAINTAINED AND REPLACED AS REQUIRED DURING THE MAINTENANCE PERIOD. TURFING / LANDSCAPE GRASS SHALL ALSO BE PLACED TO THE FULL WIDTH OF ROAD SWALE DRAINS UPON COMPLETION.
9.	SOIL AND SEDIMENT PROTECTION TO BE PROVIDED AND THOROUGHLY MAINTAINED AROUND DRAINAGE SYSTEM FOR THE DURATION OF WORKS. DIVERSION OF WATER AND THE PROTECTION OF WORKS IS THE CONTRACTORS RESPONSIBILITY.
10.	LOTS REQUIRING FILL SHALL BE CONSTRUCTED TO LEVEL 1 SUPERVISION WITH TESTING AND DOCUMENTATION SUITABLE TO DETERMINE FUTURE LOT CLASSIFICATION.
11.	CONTROLLED EARTHWORKS SHALL BE CERTIFIED BY A N.A.T.A REGISTERED LABORATORY. ALL TEST CERTIFICATION AND PLANS LOCATION TO BE SUBMITTED TO THE PRINCIPAL AND SHALL BE TO COUNCILS SATISFACTION

SITEWORKS NOTES	
1.	ORIGIN OF LEVELS :- AUSTRALIAN HEIGHT DATUM (A.H.D.)
2.	CONTRACTOR MUST VERIFY ALL DIMENSIONS AND EXISTING LEVELS ON SITE PRIOR TO COMMENCEMENT OF WORK.
3.	ALL WORK IS TO BE UNDERTAKEN IN ACCORDANCE WITH THE DETAILS SHOWN ON THE DRAWINGS, THE SPECIFICATIONS AND THE DIRECTIONS OF THE PRINCIPAL'S REPRESENTATIVE.
4.	EXISTING SERVICES HAVE BEEN PLOTTED FROM SUPPLIED DATA AND AS SUCH THEIR ACCURACY CANNOT BE GUARANTEED. IT IS THE RESPONSIBILITY OF THE CONTRACTOR TO ESTABLISH THE LOCATION AND LEVEL OF ALL EXISTING SERVICES PRIOR TO THE COMMENCEMENT OF ANY WORK. ANY DISCREPANCIES SHALL BE REPORTED TO THE PRINCIPAL'S REPRESENTATIVE. CLEARANCES SHALL BE OBTAINED FROM THE RELEVANT SERVICE AUTHORITY.
5.	WHERE NEW WORKS ABUT EXISTING THE CONTRACTOR SHALL ENSURE THAT A SMOOTH EVEN PROFILE, FREE FROM ABRUPT CHANGES IS OBTAINED.
6.	THE CONTRACTOR SHALL ARRANGE ALL SURVEY SETOUT TO BE CARRIED OUT BY A REGISTERED SURVEYOR.
7.	CARE IS TO BE TAKEN WHEN EXCAVATING NEAR EXISTING SERVICES. NO MECHANICAL EXCAVATIONS ARE TO BE UNDERTAKEN OVER COMMUNICATIONS OR ELECTRICAL SERVICES. HAND EXCAVATE IN THESE AREAS.
8.	ALL SERVICE TRENCHES UNDER VEHICULAR PAVEMENTS SHALL BE BACKFILLED WITH AN APPROVED NON-NATURAL GRANULAR MATERIAL AND COMPACTED TO 98% STANDARD MAXIMUM DRY DENSITY IN ACCORDANCE WITH AS.1289.5.1.1.
9.	ALL TRENCH BACKFILL MATERIAL SHALL BE COMPACTED TO THE SAME DENSITY AS THE ADJACENT MATERIAL.
10.	ON COMPLETION OF PIPE INSTALLATION ALL DISTURBED AREAS MUST BE RESTORED TO ORIGINAL, INCLUDING KERBS, FOOTPATHS, CONCRETE AREAS, GRAVEL AND GRASSED AREAS AND ROAD PAVEMENTS.
11.	PROVIDE 12mm WIDE EXPANDING CORK JOINTS BETWEEN CONCRETE PAVEMENTS AND ALL BUILDINGS, WALLS, FOOTINGS, COLUMNS, KERBS, DISH DRAINS, GRATED DRAINS, BOLLARD FOOTINGS ETC
12.	CONTRACTOR TO OBTAIN ALL AUTHORITY APPROVALS.
13.	ALL BATTERS TO BE GRASSED LINED WITH MINIMUM 100 TOPSOIL AND APPROVED COUCH LAID AS TURF.
14.	MAKE SMOOTH TRANSITION TO EXISTING SERVICES AND MAKE GOOD.
15.	THE CONTRACTOR SHALL PROVIDE ALL TEMPORARY DIVERSION DRAINS AND MOUNDS TO ENSURE THAT AT ALL TIMES EXPOSED SURFACES ARE FREE DRAINING AND WHERE NECESSARY EXCAVATE SUMPS AND PROVIDE PUMPING EQUIPMENT TO DRAIN EXPOSED AREAS.
16.	THESE PLANS SHALL BE READ IN CONJUNCTION WITH APPROVED ARCHITECTURAL, STRUCTURAL, HYDRAULIC AND ELECTRICAL DRAWINGS AND SPECIFICATIONS.
17.	TRENCHES THROUGH EXISTING ROAD AND CONCRETE PAVEMENTS SHALL BE SAWCUT TO FULL DEPTH OF CONCRETE AND A MIN 50mm IN BITUMINOUS PAVING.
18.	ON COMPLETION OF WORKS ALL DISTURBED AREAS MUST BE RESTORED TO ORIGINAL INCLUDING, BUT NOT LIMITED TO, KERBS, FOOTPATHS, CONCRETE AREAS, GRASS AND LANDSCAPED AREAS.

STORMWATER NOTES	
1.	MINIMUM GRADE TO STORMWATER LINES TO BE 1% (J.N.O.)
2.	CONTRACTOR TO SUPPLY AND INSTALL ALL FITTINGS AND SPECIALS INCLUDING VARIOUS PIPE ADAPTORS TO ENSURE PROPER CONNECTION BETWEEN DISSIMILAR PIPEWORK.
3.	ALL CONNECTIONS TO EXISTING DRAINAGE PITS SHALL BE MADE IN A TRADESMAN-LIKE MANNER AND THE INTERNAL WALL OF THE PIT AT THE POINT OF ENTRY SHALL BE CEMENT RENDERED TO ENSURE A SMOOTH FINISH.
4.	PRECAST PITS SHALL NOT BE USED UNLESS WRITTEN APPROVAL IS OBTAINED FROM THE SUPERINTENDENT.
5.	WHERE TRENCHES ARE IN ROCK, THE PIPE SHALL BE BEDDED ON A MIN. 50MM CONCRETE BED (OR 75MM THICK BED OF 12MM BLUE METAL) UNDER THE BARREL OF THE PIPE. THE PIPE COLLAR AT NO POINT SHALL BEAR ON THE ROCK. IN OTHER THAN ROCK, PIPES SHALL BE LAID ON A 75MM THICK SAND BED. IN ALL CASES BACKFILL THE TRENCH WITH SAND TO 200MM ABOVE THE PIPE. WHERE THE PIPE IS UNDER PAVEMENTS BACKFILL REMAINDER OF TRENCH WITH SAND OR APPROVED GRANULAR BACKFILL COMPACTED IN 150MM LAYERS TO 98% STANDARD MAX. DRY DENSITY.
6.	BEDDING SHALL BE (J.N.O.) TYPE H1, IN ACCORDANCE WITH CURRENT RELEVANT AUSTRALIAN STANDARDS.
7.	WHERE SUBSOIL DRAINAGE LINES PASS UNDER FLOOR SLABS AND VEHICULAR PAVEMENTS UNSLOTTED UPVC SEWER GRADE PIPE SHALL BE USED.
8.	WHERE PVC PIPES ARE WITHIN THE STRUCTURAL ZONE OF INFLUENCE FROM FOOTINGS / FOUNDATIONS, PIPES TO BE CONCRETE ENCASED WITH MIN 50mm THICK 25MPa cONCRETE.

COMPACTION NOTES											
1.	STRIP TOPSOIL TO EXPOSE NATURALLY OCCURRING MATERIAL AND STOCKPILE ON SITE FOR SELECTIVE RE-USE OR DISPOSE OFF-SITE AS DIRECTED BY THE SUPERINTENDENT.										
2.	WHERE FILLING IS REQUIRED TO ACHIEVE DESIGN SUBGRADE PROOF ROLL EXPOSED NATURAL SURFACE WITH A MINIMUM OF TEN PASSES OF A VIBRATING ROLLER (MINIMUM STATIC WEIGHT OF 10 TONNES) IN THE PRESENCE OF THE SUPERINTENDENT. REFER TO SPECIFICATION FOR DETAILS.										
3.	ALL SOFT, WET OR UNSUITABLE MATERIAL TO BE REMOVED AS DIRECTED BY THE SUPERINTENDENT AND REPLACED WITH APPROVED MATERIAL SATISFYING THE REQUIREMENTS LISTED BELOW.										
4.	ALL FILL MATERIAL SHALL BE FROM A SOURCE APPROVED BY THE SUPERINTENDENT AND SHALL COMPLY WITH THE FOLLOWING : <ul style="list-style-type: none">a. FREE FROM ORGANIC, PERISHABLE AND CONTAMINATED MATTERb. MAXIMUM PARTICLE SIZE 75MMc. PLASTICITY INDEX BETWEEN 2% AND 15%										
5.	ALL FILL MATERIAL SHALL BE PLACED IN MAXIMUM 200MM THICK LAYERS AND COMPACTED AT OPTIMUM MOISTURE CONTENT (+ OR - 2%) TO ACHIEVE A DRY DENSITY DETERMINED IN ACCORDANCE WITH AS 1289 E3.1 OF NOT LESS THAN THE FOLLOWING STANDARD MINIMUM DRY DENSITY IN ACCORDANCE WITH AS 1289 E1.1 : <table><thead><tr><th>LOCATION</th><th>STANDARD DRY DENSITY</th></tr></thead><tbody><tr><td>UNDER BUILDING SLABS</td><td>98%</td></tr><tr><td>AREAS OF SERVICE TRENCHES</td><td>98%</td></tr><tr><td>EXTERNAL PAVED AREAS, ROADS AND CARPARKS</td><td>98%</td></tr><tr><td>LANDSCAPED AREAS</td><td>90%</td></tr></tbody></table>	LOCATION	STANDARD DRY DENSITY	UNDER BUILDING SLABS	98%	AREAS OF SERVICE TRENCHES	98%	EXTERNAL PAVED AREAS, ROADS AND CARPARKS	98%	LANDSCAPED AREAS	90%
LOCATION	STANDARD DRY DENSITY										
UNDER BUILDING SLABS	98%										
AREAS OF SERVICE TRENCHES	98%										
EXTERNAL PAVED AREAS, ROADS AND CARPARKS	98%										
LANDSCAPED AREAS	90%										
6.	THE CONTRACTOR SHALL PROGRAM THE EARTHWORKS OPERATION SO THAT THE WORKING AREAS ARE ADEQUATELY DRAINED DURING THE PERIOD OF CONSTRUCTION. THE SURFACE SHALL BE GRADED AND SEALED OFF TO REMOVE DEPRESSIONS, ROLLER MARKS AND SIMILAR WHICH WOULD ALLOW WATER TO POND AND PENETRATE THE UNDERLYING MATERIAL. ANY DAMAGE RESULTING FROM THE CONTRACTOR NOT OBSERVING THESE REQUIREMENTS SHALL BE RECTIFIED BY THE CONTRACTOR AT THEIR COST.										
7.	TESTING OF THE SUBGRADE SHALL BE CARRIED OUT BY AN APPROVED NATA REGISTERED LABORATORY AT THE CONTRACTORS EXPENSE.										

CIVIL LEGEND PROPOSED	
 STORMWATER OVERLAND FLOW PATH
 RETAINING WALL
 STORMWATER DRAINAGE HEADWALL
 STORMWATER DRAINAGE STRUCTURE WITH NUMBER
 STORMWATER DRAINAGE LINE AND SIZE
 DESIGN LEVEL
 PROPOSED SEWER LINE
 EXISTING SEWER LINE
 GROSS POLLUTANT TRAP
 SEWER MANHOLE
 PROPOSED GRATED TRENCH DRAIN

DIAL BEFORE YOU DIG

DIAL BEFORE YOU DIG
www.1100.com.au

IMPORTANT: THE CONTRACTOR IS TO MAINTAIN A CURRENT SET OF "DIAL BEFORE YOU DIG" DRAWINGS ON SITE AT ALL TIMES.

© COPYRIGHT of this design and plan is the property of ACOR Consultants Pty Ltd. ACN 079 306 246 ABN 40 079 306 246, all rights reserved. It must not be used, modified, reproduced or copied wholly or in part without written permission from ACOR Consultants Pty Ltd.

This drawing has been assigned an electronic code that signifies the drawing has been checked and approved by:

C	ISSUE FOR DA	12.08.20	KBM	TF
B	ISSUE FOR DA	10.08.20	DV	TF
A	ISSUE FOR DA	07.08.20	DV	-
Issue	Description	Date	Drawn	Approved
<div><div>0</div><div>1cm at full size</div><div>10cm</div><div>20cm</div></div>				

Client
PATHWAYS PROPERTY GROUP

40 CHANDOS STREET
ST LEONARDS, NSW, 2065
PHONE : 1800 825 586

Architect
MORRISON DESIGN PARTNERSHIP ARCHITECTS

302/69 CHRISSTIE STREET
ST LEONARDS, NSW, 2065
PHONE : 9966 5666



ENGINEERS | MANAGERS | INFRASTRUCTURE PLANNERS | DEVELOPMENT CONSULTANTS

ACOR Consultants Pty Ltd
Suite 2, Level 1, 33 Herbert Street
St Leonards NSW 2065
T +61 2 9438 5098



Project
LONGUEVILLE AGED CARE DEVELOPMENT

16 NORTHWOOD ROAD
NORTHWOOD, NSW, 2066

Drawing Title
NOTES, LEGENDS, DETAILS

Drawn DV	Date AUG 20	Scale NTS	A1	Q.A. Check -	Date -
Designed DV	Project No. NSW200613	Dwg. No. DAC1.02	Issue C		

S:\2020\200613\Longueville\DWG\200613_1_DAC1.02.dwg
Aug 25, 2020 - 2:54pm

DRAWING UNDER REVISION

NOT FOR CONSTRUCTION

CIVIL LEGEND PROPOSED

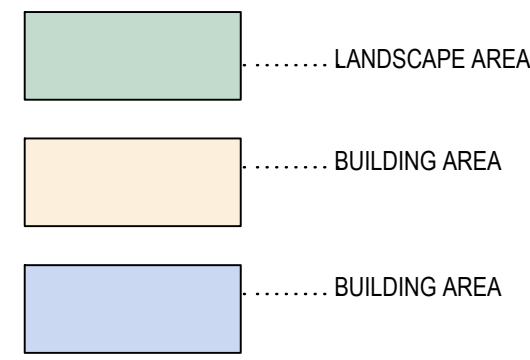

PRRWAY 3.5 WIDE & VARIABLE (D.P. 857133)
#1 TO DRAIN WATER OVER EXISTING PITS & LUMEN (D.P. 857133)
ASEMENT FOR SERVICES 3.5 WIDE (D.P. 857133)
EASEMENT FOR STORAGE 0.6 WIDE (D.P. 857133)
STORMWATER DETENTION AREA (D.P. 857133)

PROPOSED SEWER MANHOLE
(INDICATIVE ONLY)PROPOSED RETAINING WALL TO
STRUCTURAL ENGINEER DETAILSPROPOSED CONCRETE
GRATED STORMWATER
PIT (TYP.)PROPOSED RETAINING
WALLOSD GRATED ACCESS LID (900 x 900)
PROVIDE CHILD PROOF
LOCKING SYSTEMPROPOSED GABION BASKET RETAINING
WALL TO STRUCTURAL ENGINEER DETAILSØ375 PERFORATED PIPE AT 0% LONGITUDINAL
GRADE TO DISCHARGE THROUGH GABION
RETAINING WALL.
80 PIPE PENETRATION OF 50mm SPREAD
EVENLY OVER THE FULL LENGTH OF THE
PIPES WITH MIN SPACING OF 200mm CENTRES.OSD GRATED ACCESS LID (900 x 900)
PROVIDE CHILD PROOF LOCKING SYSTEMOCEANGUARD TO BE
INSTALLED IN ALL GRATED
PITS EXCEPT OSDBELOW GROUND ON-SITE
DETENTION TANK
VOLUME= 89m³ (DEPTH =
1.5m + 300mm FREEBOARD)ALL ROOF, BALCONY
DRAINAGE AND BASEMENT
PUMPOUT TO CONNECT
DIRECTLY INTO THE OSD
TANK (REFER HYDRAULIC
ENGINEER FOR DETAILS)

LOWER GROUND FLOOR

EXISTING SEWER MANHOLE

SITE
BOUNDARYAPPROVED
GRANULAR FILL70mm RIP RAP,
MINIMUM PIPE
SURROUND OF
150mm THICKØ375
PERFORATED
PVC PIPE50mm
PERFORATIONS
AT MIN 200mm
CENTRESMASS CONCRETE
FOOTING
(SHOWN
INDICATIVELY)TYPICAL GABION CAGE RETAINING WALL
WITH PERFORATED PIPE

N.T.S

GABION RETAINING WALL (SHOWN INDICATIVELY). TO BE
DESIGN BY STRUCTURAL ENGINEER IN DETAILED DESIGN

PLAN

SCALE 1:200 @ A1
SCALE 1:400 @ A3

NORTHWOOD

DRAWING UNDER REVISION

NOT FOR CONSTRUCTION

© COPYRIGHT of this design and plan is the property of ACOR Consultants Pty Ltd. ACN 079 306 246 ABN 40 079 306 246, all rights reserved. It must not be used, modified, reproduced or copied wholly or in part without written permission from ACOR Consultants Pty Ltd.

This drawing has been assigned an electronic code that signifies the drawing has been checked and approved by:

E	ISSUE FOR DA	27.08.20	ROB	TF
D	ISSUE FOR DA	25.08.20	ROB	TF
C	ISSUE FOR DA	12.08.20	KBM	TF
B	ISSUE FOR DA	10.08.20	KBM	TF
Issue	Description	Date	Drawn	Approved

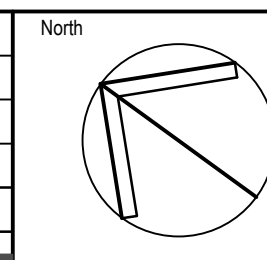

Client
**PATHWAYS PROPERTY
GROUP**

40 CHANDOS STREET
ST LEONARDS, NSW, 2065
PHONE : 1800 825 586

Architect
**MORRISON DESIGN
PARTNERSHIP ARCHITECTS**

302/69 CHRISSTIE STREET
ST LEONARDS, NSW, 2065
PHONE : 9966 5566



ACOR Consultants Pty Ltd
Suite 2, Level 1, 33 Herbert Street
St Leonards NSW 2065
T +61 2 9438 5098



Project
**LONGUEVILLE AGED CARE
DEVELOPMENT**

16 NORTHWOOD ROAD
NORTHWOOD, NSW, 2066

Drawing Title
GENERAL ARRANGEMENT PLAN

Drawn DV	Date AUG 2020	Scale 1:200	A1	Q.A. Check	Date
Designed DV	Project No. NSW200613	Dwg. No. DAC2.01	Issue E		



© COPYRIGHT of this design and plan is the property of ACOR Consultants Pty Ltd. ACN 079 306 246 ABN 40 079 306 246, all rights reserved. It must not be used, modified, reproduced or copied wholly or in part without written permission from ACOR Consultants Pty Ltd.

This drawing has been assigned an electronic code that signifies the drawing has been checked and approved by:

Issue	Description	Date	Drawn	Approved
C	ISSUE FOR DA	12.08.20	KBM	TF
B	ISSUE FOR DA	07.08.20	DV	TF
A	ISSUE FOR DA	07.08.20	DV	-

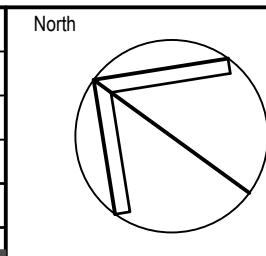

Client
PATHWAYS PROPERTY GROUP
40 CHANDOS STREET
ST LEONARDS, NSW, 2065
PHONE : 1800 825 586

Architect
MORRISON DESIGN PARTNERSHIP ARCHITECTS
302/69 CHRISSTIE STREET
ST LEONARDS, NSW, 2065
PHONE : 9966 5566



ACOR Consultants Pty Ltd
Suite 2, Level 1, 33 Herbert Street
St Leonards NSW 2065
T +61 2 9438 5098
16 NORTHWOOD ROAD
NORTHWOOD, NSW, 2066

Project
LONGUEVILLE AGED CARE DEVELOPMENT

Drawing Title
CATCHMENT PLAN

Drawn	Date	Scale	A1	Q.A. Check	Date
DV	AUG 20	1:200	-	-	-
Designed	Project No.	Dwg. No.	Issue		
DV	NSW200613	DAC2.11	C		

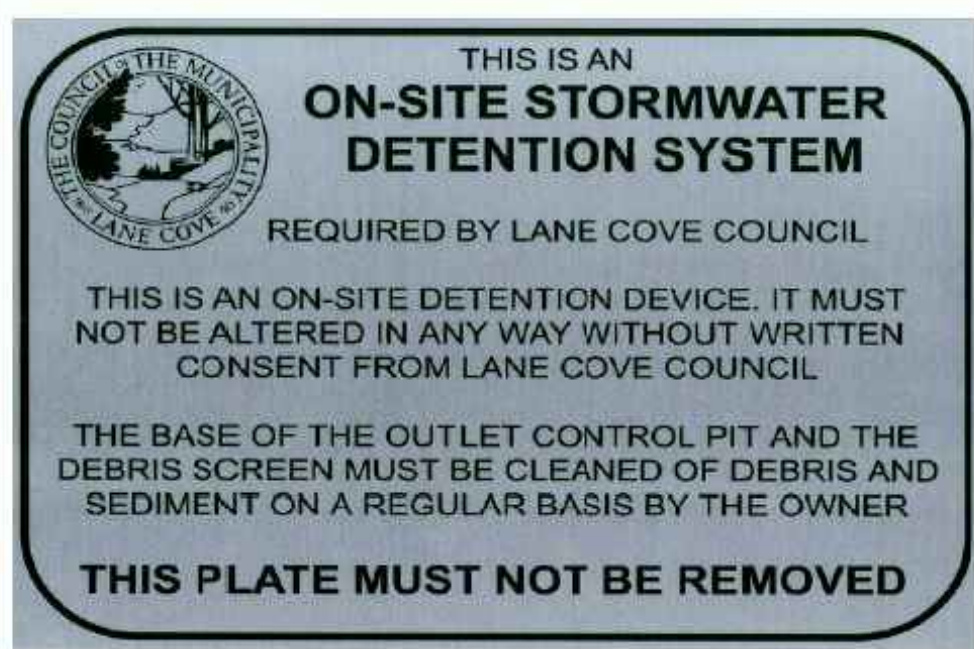
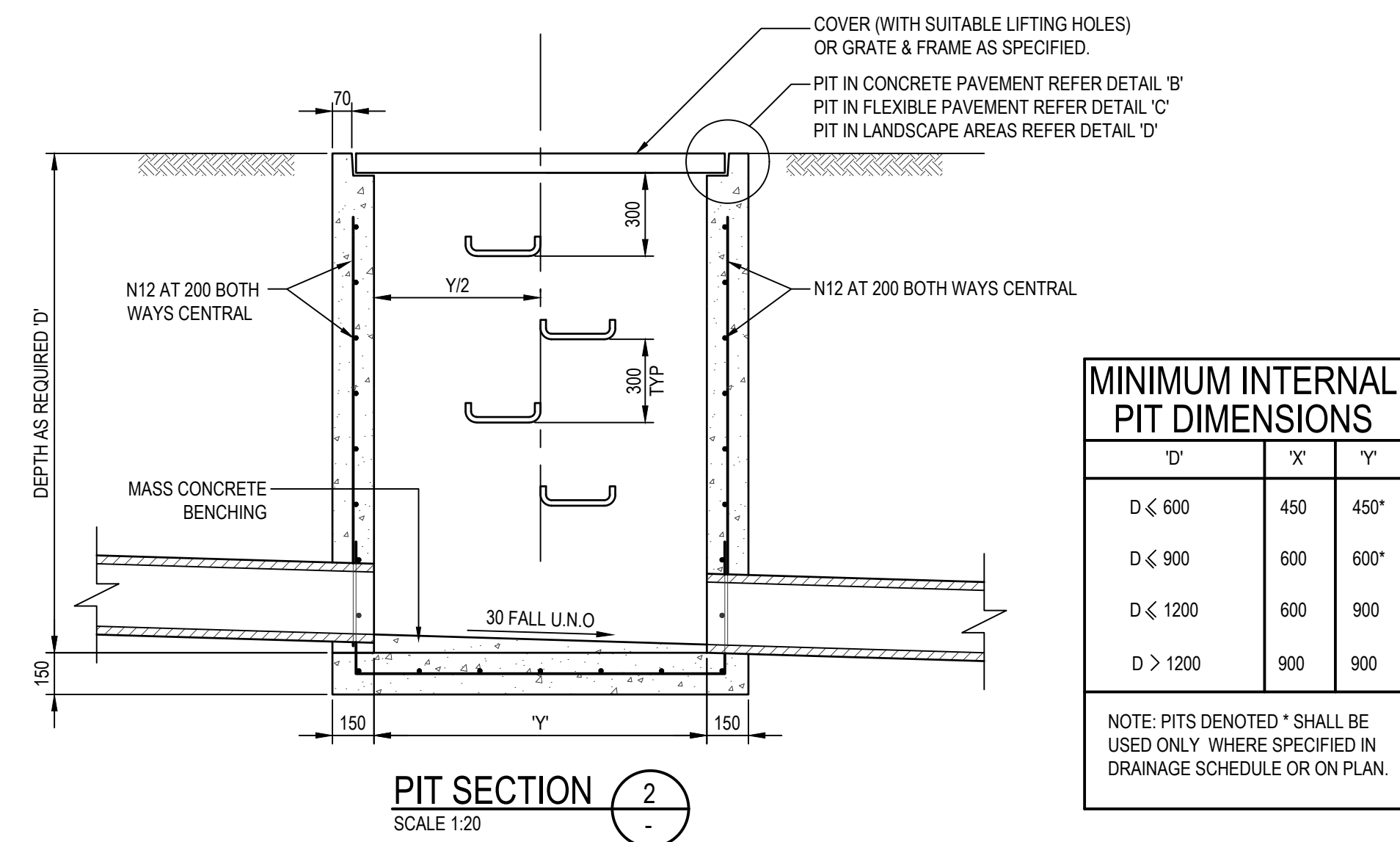

FRONT ELEVATION

SIDE ELEVATION

PLAN

SECTION

20 DIA. GALVANISED MILD STEEL

Technical drawing of a trash screen detail, showing a perspective view of a rectangular frame with a mesh screen. The drawing includes the following labels and dimensions:

- GALVANISED LYSAGHT RH3030 MAXIMESH TO FRONT AND THREE (3) SIDES ONLY AREA: 0.2m² MIN**: Points to the mesh screen.
- OUTLET PIPE BEYOND**: Points to the pipe extending from the top of the frame.
- STEEL PLATE CLIP WELDED TO BASKET GALV. TYPICAL EITHER SIDE**: Points to a clip on the side of the frame.
- STEEL PLATE BRACKET GALV. FIXED TO FIT WALL WITH 2 LIXONS TO SEAT CLIPS INTO**: Points to a bracket on the side of the frame.
- HANDLE**: Points to a handle on the front of the frame.
- 900**: Dimensioned three times, indicating the width, depth, and height of the frame.
- NOT TO SCALE**: Located at the bottom of the drawing.

40 220 40

300x300 x 4 PL 316SS 4
HOLES 12 DIA FOR M10
CHEMSETS

Ø150mm ORIFICE

300

COVER OR GRATE AND FRAME AS SPECIFIED REFER PIT SCHEDULE

70 MIN

MO

PIT SPE

RECESS TO SUIT COVER OR FRAME

COVER OR GRATE AND FRAME AS SPECIFIED REFER PIT SCHEDULE

70 MIN

125

MORTAR BEDDING

PIT WALL REINFORCED AS SPECIFIED

RECESS TO SUIT COVER OR FRAME

R BEDDING

This drawing has been assigned an electronic code that signifies the drawing has been checked and approved by:

C	ISSUE FOR DA	12.08.20	KBM	TF
B	ISSUE FOR DA	10.08.20	KBM	TF
A	ISSUE FOR DA	07.08.20	KBM	TF
Issue	Description	Date	Drawn	Approved
1	2	3	4	5

Architect

MORRISON DESIGN
PARTNERSHIP ARCHITECTS

302/69 CHRISTIE STREET
ST LEONARDS, NSW, 2065
PHONE : 9966 5566



ACOR Consultants Pty Ltd
Suite 2, Level 1, 33 Herbert Street
St Leonards NSW 2065
T +61 2 9438 5098

STRUCTURE PLANNERS | DEVELOPMENT CONSULTANTS

Drawing Title	OSD SECTION AND DETAILS
---------------	-------------------------

Drawn KBM	Date AUG 2020	Scale AS SHOWN	A1 Q.A. Check Date	
Designed KBM	Project No. NSW200613		Dwg. No. DAC2.21	Issue C

DRAWING UNDER REVISION

NOT FOR CONSTRUCTION

Aug 25, 2020 - 5:36pm S:\NSV20\new2016\Drawings - cad\CADDrawings\DWG\NSV200613_DAC2.21.dwg

EROSION AND SEDIMENT CONTROL LEGEND

SEDIMENT CONTROL FENCE (STAGE 1)

BARRIER FENCE

TEMPORARY CONSTRUCTION ACCESS

DRAIN - LOW FLOW

DROP INLET SEDIMENT FILTER

SEDIMENT FILTER

EROSION AND SEDIMENT CONTROL NOTES

1.

THIS DRAWING IS FOR GUIDANCE PURPOSES ONLY - THE SOIL AND EROSION CONTROLS ARE INDICATIVE AND REMAIN SUBJECT TO CONSTRUCTION METHODOLOGY - THE CONTRACTOR SHALL AT ALL TIMES REMAIN RESPONSIBLE FOR COMPLIANCE WITH ALL LAWS AND REGULATIONS PERTAINING TO SAFETY AND PROTECTION OF ENVIRONMENT

2.

ALL SOIL AND EROSION CONTROLS TO BE INSTALLED AND MAINTAINED IN ACCORDANCE WITH COUNCIL GUIDELINES AND CONDITIONS AND THE CURRENT NSW GOVERNMENT "MANAGING URBAN STORMWATER - SOILS AND CONSTRUCTION" HANDBOOK

3.

CONTRACTOR TO ENSURE THAT SEDIMENT IS NOT ALLOWED TO ENTER ADJACENT LOTS TO DOWNSTREAM STORMWATER SYSTEMS. ANY DAMAGE WHATSOEVER CAUSED THROUGH BREACH OF THIS CONDITION BY THE CONTRACTOR SHALL BE RECTIFIED SOLELY AT THE CONTRACTORS COST

4.

ANY FINE, FEE, LEVY OR THE LIKE IMPOSED BY THE REGULATORY AUTHORITY AS A CONSEQUENCE OF THE CONTRACTORS ACTS OR OMISSIONS SHALL BE PAID BY THE CONTRACTOR EITHER DIRECTLY OR INDIRECTLY VIA CREDIT OR VARIATION TO THE CONTRACT SUM

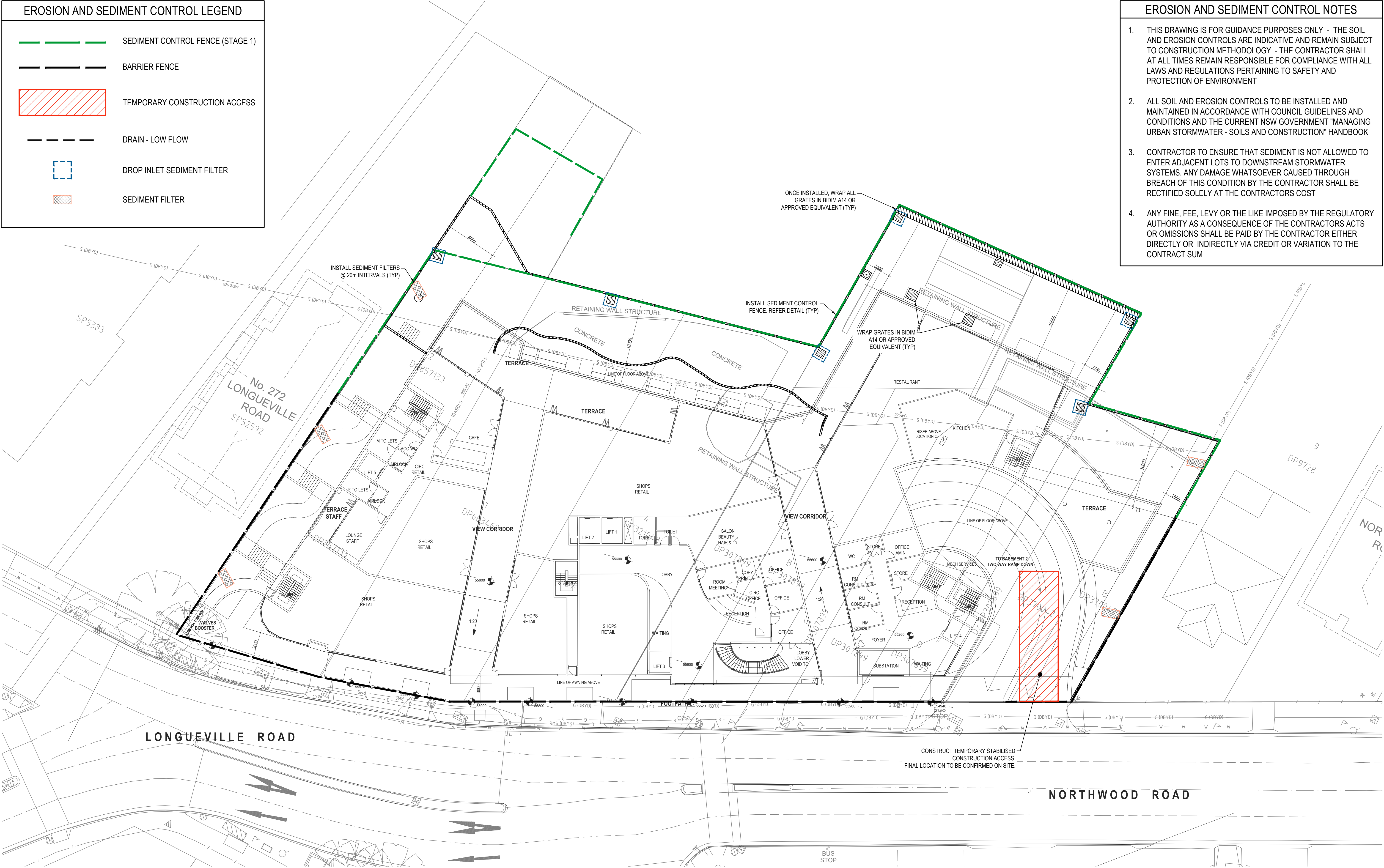

© COPYRIGHT of this design and plan is the property of ACOR Consultants Pty Ltd. ACN 079 306 246 ABN 40 079 306 246, all rights reserved. It must not be used, modified, reproduced or copied wholly or in part without written permission from ACOR Consultants Pty Ltd.

This drawing has been assigned an electronic code that signifies the drawing has been checked and approved by:			
D	ISSUE FOR DA	28.08.20	KBM TF
C	ISSUE FOR DA	12.08.20	KBM TF
B	ISSUE FOR DA	10.08.20	KBM TF
A	ISSUE FOR DA	07.08.20	KBM TF
Issue	Description	Date	Drawn Approved

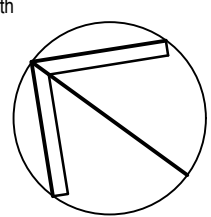

Client
PATHWAYS PROPERTY GROUP

40 CHANDOS STREET
ST LEONARDS, NSW, 2065
PHONE : 1800 825 586

Architect
MORRISON DESIGN PARTNERSHIP ARCHITECTS

302/69 CHRISSTIE STREET
ST LEONARDS, NSW, 2065
PHONE : 9966 5566



ENGINEERS | MANAGERS | INFRASTRUCTURE PLANNERS | DEVELOPMENT CONSULTANTS

ACOR Consultants Pty Ltd
Suite 2, Level 1, 33 Herbert Street
St Leonards NSW 2065
T +61 2 9438 5098

Project
LONGUEVILLE AGED CARE DEVELOPMENT

16 NORTHWOOD ROAD
NORTHWOOD, NSW, 2066

Drawing Title SOIL EROSION AND SEDIMENT CONTROL PLAN			
Drawn KBM	Date AUG 2020	Scale 1:200	A1
Designed KBM	Project No. NSW200613	Dwg. No. DAC7.01	Issue D

SCALE 1:200 @ A1
SCALE 1:400 @ A3



DRAWING UNDER REVISION **NOT FOR CONSTRUCTION**

EROSION AND SEDIMENT CONTROL NOTES

GENERAL INSTRUCTIONS

1.

THIS SOIL AND WATER MANAGEMENT PLAN IS TO BE READ IN CONJUNCTION WITH OTHER ENGINEERING PLANS RELATING TO THIS DEVELOPMENT.

2.

CONTRACTORS WILL ENSURE THAT ALL SOIL AND WATER MANAGEMENT WORKS ARE UNDERTAKEN AS INSTRUCTED IN THIS SPECIFICATION AND CONSTRUCTED FOLLOWING THE GUIDELINES OF "MANAGING URBAN STORMWATER SOILS AND CONSTRUCTION", DEPT OF HOUSING, 1998 (BLUE BOOK).

3.

ALL SUBCONTRACTORS WILL BE INFORMED OF THEIR RESPONSIBILITIES IN REDUCING THE POTENTIAL FOR SOIL EROSION AND POLLUTION TO DOWNSLOPE AREAS.

LAND DISTURBANCE INSTRUCTIONS

1.

DISTURBANCE TO BE NO FURTHER THAN 5 (PREFERABLY 2) METRES FROM THE EDGE OF ANY ESSENTIAL ENGINEERING ACTIVITY AS SHOWN ON APPROVED PLANS. ALL SITE WORKERS WILL CLEARLY RECOGNISE THESE ZONES THAT, WHERE APPROPRIATE, ARE IDENTIFIED WITH BARRIER FENCING (UPSLOPE) AND SEDIMENT FENCING (DOWNSLOPE) OR SIMILAR MATERIALS.

2.

ACCESS AREAS ARE TO BE LIMITED TO A MAXIMUM WIDTH OF 10 METRES THE SITE MANAGER WILL DETERMINE AND MARK THE LOCATION OF THESE ZONES ON-SITE. ALL SITE WORKERS WILL CLEARLY RECOGNISE THESE BOUNDARIES THAT, WHERE APPROPRIATE, ARE IDENTIFIED WITH BARRIER FENCING (UPSLOPE) AND SEDIMENT FENCING (DOWNSLOPE) OR SIMILAR MATERIALS.

3.

ENTRY TO LANDS NOT REQUIRED FOR CONSTRUCTION OR ACCESS IS PROHIBITED EXCEPT FOR ESSENTIAL THINNING OF PLANT GROWTH.

4.

WORKS ARE TO PROCEED IN THE FOLLOWING SEQUENCE:

a.

INSTALL ALL BARRIER AND SEDIMENT FENCING WHERE SHOWN ON THE PLAN.

b.

CONSTRUCT THE STABILISED SITE ACCESS.

c.

CONSTRUCT DIVERSION DRAINS AS REQUIRED.

d.

INSTALL MESH AND GRAVEL INLETS FOR ANY ADJACENT KERB INLETS.

e.

INSTALL GEOTEXTILE INLET FILTERS AROUND ANY ON-SITE DROP INLET PITS.

f.

CLEAR SITE AND STRIP AND STOCKPILE TOPSOIL IN LOCATIONS SHOWN ON THE PLAN.

g.

UNDERTAKE ALL ESSENTIAL CONSTRUCTION WORKS ENSURING THAT ROOF AND/OR PAVED AREA STORMWATER SYSTEMS ARE CONNECTED TO PERMANENT DRAINAGE AS SOON AS PRACTICABLE.

h.

GRADE LOT AREAS TO FINAL GRADES AND APPLY PERMANENT STABILISATION (LANDSCAPING) WITHIN 20 DAYS OF COMPLETION OF CONSTRUCTION WORKS.

i.

REMOVE TEMPORARY EROSION CONTROL MEASURES AFTER THE PERMANENT LANDSCAPING HAS BEEN COMPLETED.

5.

ENSURE THAT SLOPE LENGTHS DO NOT EXCEED 80 METRES WHERE PRACTICABLE. SLOPE LENGTHS ARE DETERMINED BY SILTATION FENCING AND CATCH DRAIN SPACING. 6. ON COMPLETION OF MAJOR WORKS LEAVE DISTURBED LANDS WITH A SCARIFIED SURFACE TO ENCOURAGE WATER INFILTRATION AND ASSIST WITH KEYING TOPSOIL LATER.

6.

CONTRACTOR TO MANAGE THE ALIGNMENT OF CATCH DRAINS ON SITE AND TO ENSURE THAT CATCH DRAINS INTERCEPT THE SITE SURFACE RUNOFF AND DIRECT THE RUNOFF TOWARDS THE SEDIMENTATION BASINS.

SITE INSPECTION AND MAINTENANCE INSTRUCTIONS

1.

THE SITE SUPERINTENDENT WILL INSPECT THE SITE AT LEAST WEEKLY AND AT THE CONCLUSION OF EVERY STORM EVENT TO:

a.

ENSURE THAT DRAINS OPERATE PROPERLY AND TO EFFECT ANY NECESSARY REPAIRS.

b.

REMOVE SPILLED SAND OR OTHER MATERIALS FROM HAZARD AREAS, INCLUDING LANDS CLOSER THAN 5 METRES FROM AREAS OF LIKELY CONCENTRATED OR HIGH VELOCITY FLOWS ESPECIALLY WATERWAYS AND PAVED AREAS.

c.

REMOVE TRAPPED SEDIMENT WHENEVER THE DESIGN CAPACITY OF THAT STRUCTURE HAS BEEN EXCEEDED.

d.

ENSURE REHABILITATED LANDS HAVE EFFECTIVELY REDUCED THE EROSION HAZARD AND TO INITIATE UPGRADING OR REPAIR AS NECESSARY.

e.

CONSTRUCT ADDITIONAL EROSION AND/OR SEDIMENT CONTROL WORKS AS MIGHT BECOME NECESSARY TO ENSURE THE DESIRED PROTECTION IS GIVEN TO DOWNSLOPE LANDS AND WATERWAYS. MAKE ONGOING CHANGES TO THE PLAN WHERE IT PROVES INADEQUATE IN PRACTICE OR IS SUBJECTED TO CHANGES IN CONDITIONS ON THE WORK-SITE OR ELSEWHERE IN THE CATCHMENT.

f.

MAINTAIN EROSION AND SEDIMENT CONTROL STRUCTURES IN A FULLY FUNCTIONING CONDITION UNTIL ALL EARTHWORK ACTIVITIES ARE COMPLETED AND THE SITE IS REHABILITATED.

2.

THE SITE SUPERINTENDENT WILL KEEP A LOGBOOK MAKING ENTRIES AT LEAST WEEKLY, IMMEDIATELY BEFORE FORECAST RAIN AND AFTER RAINFALL. ENTRIES WILL INCLUDE:

a.

THE VOLUME AND INTENSITY OF ANY RAINFALL EVENTS.

b.

THE CONDITION OF ANY SOIL AND WATER MANAGEMENT WORKS.

c.

THE CONDITION OF VEGETATION AND ANY NEED TO IRRIGATE.

d.

THE NEED FOR DUST PREVENTION STRATEGIES.

e.

ANY REMEDIAL WORKS TO BE UNDERTAKEN. THE LOGBOOK WILL BE KEPT ON-SITE AND MADE AVAILABLE TO ANY AUTHORISED PERSON UPON REQUEST. IT WILL BE GIVEN TO THE PROJECT MANAGER AT THE CONCLUSION OF THE WORKS.

EROSION AND SEDIMENT CONTROL NOTES

SEDIMENT CONTROL INSTRUCTIONS

1.

SEDIMENT FENCES WILL BE INSTALLED AS SHOWN ON THE PLAN AND ELSEWHERE AT THE DISCRETION OF THE SITE SUPERINTENDENT TO CONTAIN SOIL AS NEAR AS POSSIBLE TO THEIR SOURCE.

2.

SEDIMENT FENCES WILL NOT HAVE CATCHMENT AREAS EXCEEDING 900 SQUARE METRES AND HAVE A STORAGE DEPTH OF AT LEAST 0.6 METRES.

3.

SEDIMENT REMOVED FROM ANY TRAPPING DEVICES WILL BE RELOCATED WHERE FURTHER POLLUTION TO DOWNSLOPE LANDS AND WATERWAYS CANNOT OCCUR.

4.

STOCKPILES ARE NOT TO BE LOCATED WITHIN 5 METRES OF HAZARD AREAS INCLUDING AREAS OF HIGH VELOCITY FLOWS SUCH AS WATERWAYS, PAVED AREAS AND DRIVEWAYS.

5.

WATER WILL BE PREVENTED FROM DIRECTLY ENTERING THE PERMANENT DRAINAGE SYSTEM UNLESS THE CATCHMENT AREA HAS BEEN PERMANENTLY LANDSCAPED AND/OR WATER HAS BEEN TREATED BY AN APPROVED DEVICE. 6. TEMPORARY SEDIMENT TRAPS WILL REMAIN IN PLACE UNTIL AFTER THE LANDS THEY ARE PROTECTING ARE COMPLETELY REHABILITATED.

6.

ACCESS TO SITES SHOULD BE STABILISED TO REDUCE THE LIKELIHOOD OF VEHICLES TRACKING SOIL MATERIALS ONTO PUBLIC ROADS AND ENSURE ALL-WEATHER ENTRY/EXIT.

SOIL EROSION CONTROL INSTRUCTIONS

1.

EARTH BATTERS WILL BE CONSTRUCTED WITH AS LOW A GRADIENT AS PRACTICABLE BUT NO STEEPER, UNLESS OTHERWISE NOTED, THAN:

a.

2(H):1(V) WHERE SLOPE LENGTH LESS THAN 12 METRES

b.

2.5(H):1(V) WHERE SLOPE LENGTH BETWEEN 12 AND 16 METRES.

c.

3(H):1(V) WHERE SLOPE LENGTH BETWEEN 16 AND 20 METRES.

d.

4(H):1(V) WHERE SLOPE LENGTH GREATER THAN 20 METRES.

2.

ALL WATERWAYS, DRAINS, SPILLWAYS AND THEIR OUTLETS WILL BE CONSTRUCTED TO BE STABLE IN AT LEAST THE 1:20 YEAR ARI, TIME OF CONCENTRATION STORM EVENT.

3.

WATERWAYS AND OTHER AREAS SUBJECT TO CONCENTRATED FLOWS AFTER CONSTRUCTION ARE TO HAVE A MAXIMUM GROUND COVER C-FACTOR OF 0.05 (70% GROUND COVER) WITHIN 10 WORKING DAYS FROM COMPLETION OF FORMATION. FLOW VELOCITIES ARE TO BE LIMITED TO THOSE SHOWN IN TABLE 5-1 OF "MANAGING URBAN STORMWATER - SOILS AND CONSTRUCTION", DEPT OF HOUSING 1998 (BLUE BOOK). FOOT AND VEHICULAR TRAFFIC WILL BE PROHIBITED IN THESE AREAS.

4.

STOCKPILES AFTER CONSTRUCTION ARE TO HAVE A MAXIMUM GROUND-COVER C-FACTOR OF 0.1 (60% GROUND-COVER) WITHIN 10 WORKING DAYS FROM COMPLETION OF FORMATION.

5.

ALL LANDS, INCLUDING WATERWAYS AND STOCKPILES, DURING CONSTRUCTION ARE TO HAVE A MAXIMUM GROUND-COVER C-FACTOR OF 0.15 (50% GROUND COVER) WITHIN 20 WORKING DAYS FROM INACTIVITY EVEN THOUGH WORKS MAY CONTINUE LATER.

6.

FOR AREAS OF SHEET FLOW USE THE FOLLOWING GROUND COVER PLANT SPECIES FOR TEMPORARY COVER: JAPANESE MILLET 20 KG/HA AND OATS 20 KG/HA.

7.

PERMANENT REHABILITATION OF LANDS AFTER CONSTRUCTION WILL ACHIEVE A GROUND-COVER C-FACTOR OF LESS THAN 0.1 AND LESS THAN 0.05 WITHIN 60 DAYS. NEWLY PLANTED LANDS WILL BE WATERED REGULARLY UNTIL AN EFFECTIVE COVER IS ESTABLISHED AND PLANTS ARE GROWING VIGOROUSLY. FOLLOW-UP SEED AND FERTILISER WILL BE APPLIED AS NECESSARY.

8.

RE-VEGETATION SHOULD BE AIMED AT RE-ESTABLISHING NATURAL SPECIES. NATURAL SURFACE SOILS SHOULD BE REPLACED AND NON-PERSISTANT ANNUAL COVER CROPS SHOULD BE USED.

WASTE CONTROL INSTRUCTIONS

1.

ACCEPTABLE BINS WILL BE PROVIDED FOR ANY CONCRETE AND MORTAR SLURRIES, PAINTS, ACID WASHING, LIGHTWEIGHT WASTE MATERIALS AND LITTER. CLEARANCE SERVICES WILL BE PROVIDED AT LEAST WEEKLY. DISPOSAL OF WASTE WILL BE IN A MANNER APPROVED BY THE SITE SUPERINTENDENT.

2.

ALL POSSIBLE POLLUTANT MATERIALS ARE TO BE STORED WELL CLEAR OF ANY POORLY DRAINED AREAS, FLOOD PRONE AREAS, STREAMBANKS, CHANNELS AND STORMWATER DRAINAGE AREAS. STORE SUCH MATERIALS IN A DESIGNATED AREA UNDER COVER WHERE POSSIBLE AND WITHIN CONTAINMENT BUNDS.

3.

ALL SITE STAFF AND SUB-CONTRACTORS ARE TO BE INFORMED OF THEIR OBLIGATION TO USE WASTE CONTROL FACILITIES PROVIDED.

4.

ANY DE-WATERING ACTIVITIES ARE TO BE CLOSELY MONITORED TO ENSURE THAT WATER IS NOT POLLUTED BY SEDIMENT, TOXIC MATERIALS OR PETROLEUM PRODUCTS.

5.

PROVIDE DESIGNATED VEHICULAR WASHDOWN AND MAINTENANCE AREAS WHICH ARE TO HAVE CONTAINMENT BUNDS.

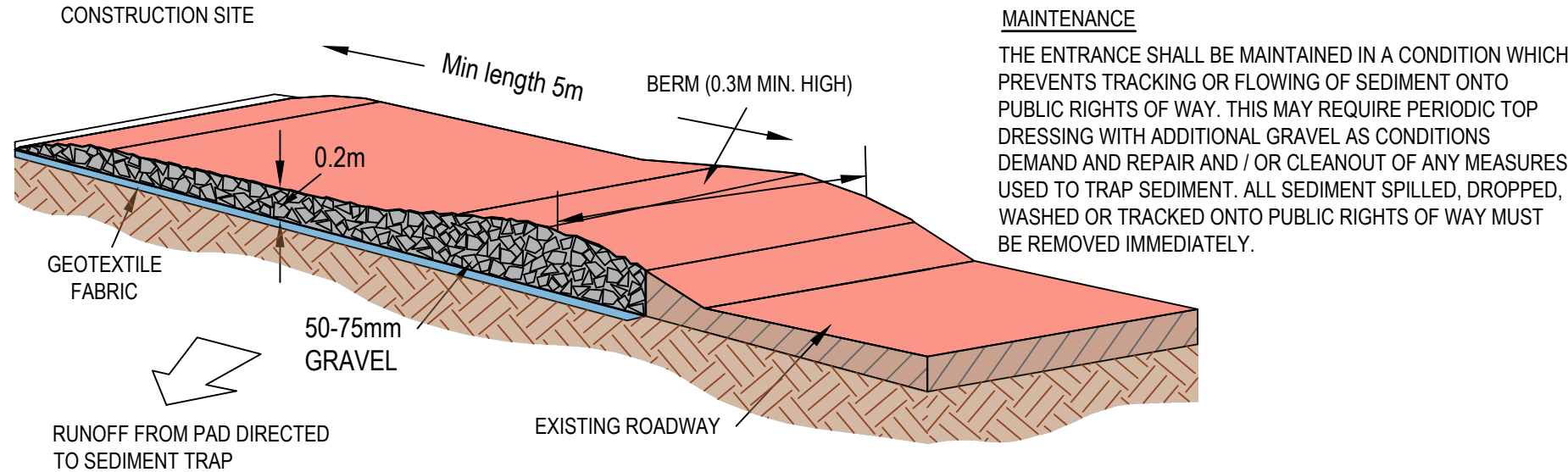

TEMPORARY CONSTRUCTION EXIT

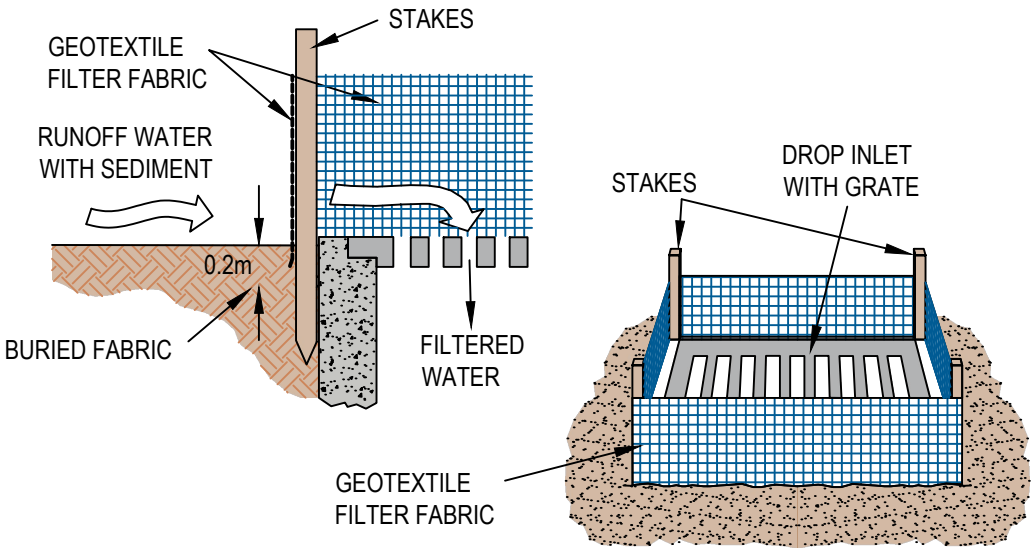

GEOTEXTILE FILTER FABRIC DROP INLET SEDIMENT TRAP

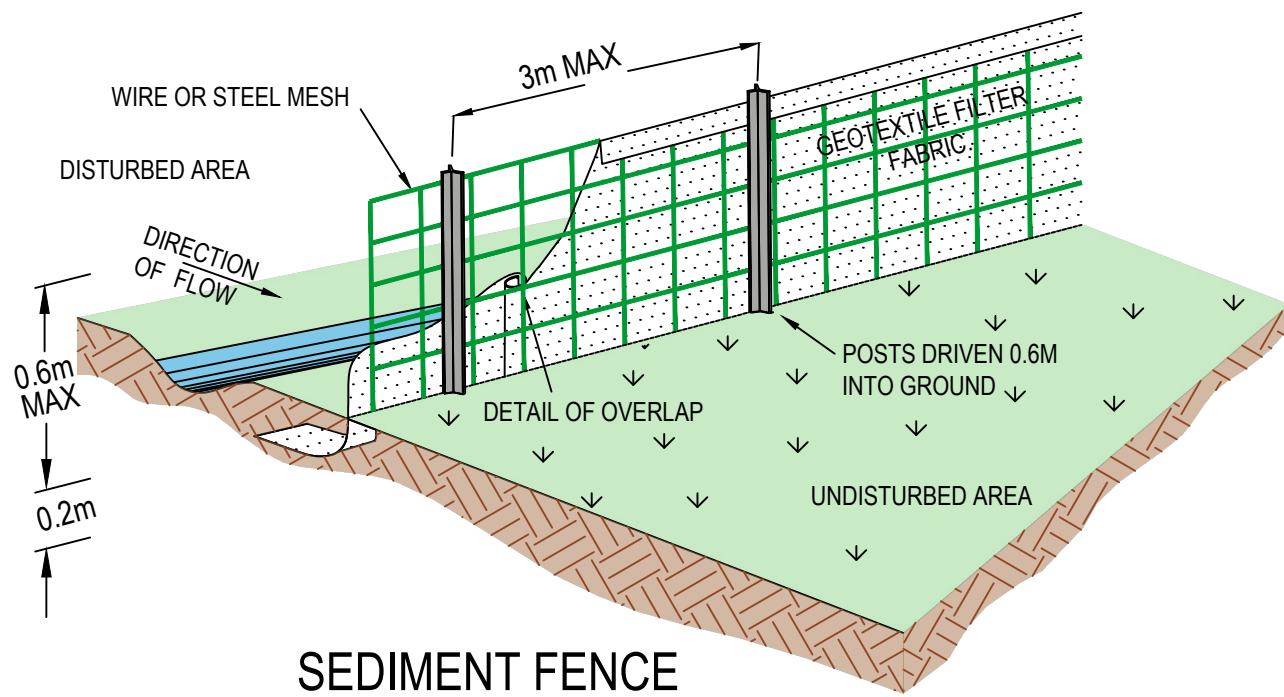

SEDIMENT FENCE

EROSION AND SEDIMENT CONTROL NOTES

IMPORTANT NOTES:

1.

THIS DRAWING IS FOR GUIDANCE PURPOSES ONLY - THE SOIL AND EROSION CONTROLS ARE INDICATIVE AND REMAIN SUBJECT TO CONSTRUCTION PROGRAMME METHODOLOGY - THE CONTRACTOR SHALL AT ALL TIMES REMAIN RESPONSIBLE FOR COMPLIANCE WITH ALL LAWS AND REGULATIONS PERTAINING TO SAFETY AND PROTECTION OF ENVIRONMENT

2.

ALL SOIL AND EROSION CONTROLS TO BE INSTALLED AND MAINTAINED IN ACCORDANCE WITH COUNCIL GUIDELINES AND CONDITIONS AND ENVIRONMENTAL CODES STANDARDS AND REGULATIONS

3.

CONTRACTOR TO ENSURE THAT SEDIMENT IS NOT ALLOWED TO ENTER ADJACENT LOTS OR TO DOWNSTREAM STORMWATER SYSTEMS.

4.

ANY DAMAGE, FINES, NOTICES ETC. RELATED TO ANY BREACH OF THESE CONDITIONS BY ANY ACT OR OMISSION OF THE CONTRACTOR OR HIS AGENTS SHALL BE RECTIFIED OR OTHERWISE ADDRESSED SOLELY AT THE CONTRACTOR'S COST INCLUDING ANY RELATED COSTS INCURRED BY THE SUPERINTENDENT OR PRINCIPAL

© COPYRIGHT of this design and plan is the property of ACOR Consultants Pty Ltd. ACN 079 306 246 ABN 40 079 306 246, all rights reserved. It must not be used, modified, reproduced or copied wholly or in part without written permission from ACOR Consultants Pty Ltd.

This drawing has been assigned an electronic code that signifies the drawing has been checked and approved by:

					North
C	ISSUED FOR DA	12.08.20	KBM	TF	
B	ISSUED FOR DA	10.08.20	DV	TF	
A	ISSUED FOR DA	07.08.20	DV	TF	
Issue	Description	Date	Drawn	Approved	
1	0	1cm at full scale			20m

Client
PATHWAYS PROPERTY GROUP

40 CHANDOS STREET
ST LEONARDS, NSW, 2065
PHONE : 1800 825 586

Architect
MORRISON DESIGN PARTNERSHIP ARCHITECTS

302/69 CHRISSTIE STREET
ST LEONARDS, NSW, 2065
PHONE : 9966 5566



ENGINEERS | MANAGERS | INFRASTRUCTURE PLANNERS | DEVELOPMENT CONSULTANTS

ACOR Consultants Pty Ltd
Suite 2, Level 1, 33 Herbert Street
St Leonards NSW 2065
T +61 2 9438 5098



Project
LONGUEVILLE AGED CARE DEVELOPMENT

16 NORTHWOOD ROAD
NORTHWOOD, NSW, 2066

Drawing Title
SEDIMENT EROSION CONTROL PLAN DETAILS

Drawn DV	Date AUG 20	Scale NTS	A1	Q.A. Check -	Date -
Designed DV	Project No. NSW200613	Dwg. No. DAC7.11	Issue B		

\\sbs02\mwa001\Drawings - acor\Drawings\2006\200613\DAC7.11.dwg
Aug 25, 2020 - 2:57 PM

Note: These "Detailed Calculation" spreadsheets relate only to high erosion hazard lands as identified in figure 4.6 or where the designer chooses to use the RUSLE to size sediment basins. The "Standard Calculation" spreadsheets should be used on low er

1. Site Data Sheet

Site Name:	NSW200613
Site Location:	16 NORTHWOOD ROAD, LANE COVE, NSW 2066
Precinct:	N/A
Description of Site:	Brown site, development area greater than 2500 m2, SWMP required. Soil loss < 150 m3/year hence, sediment basin not required.

Site area	Site						Remarks
	CAT 1						
Total catchment area (ha)	0.5						
Disturbed catchment area (ha)	0.5						

Soil analysis

% sand (faction 0.02 to 2.00 mm)	50						Soil texture should be assessed through mechanical dispersion only. Dispersing agents (e.g. Calgon) should not be used
% silt (fraction 0.002 to 0.02 mm)	10						
% clay (fraction finer than 0.002 mm)	40						
Dispersion percentage	10.0						E.g. enter 10 for dispersion of 10%
% of whole soil dispersible	4.5						See Section 6.3.3(e)
Soil Texture Group	C						See Section 6.3.3(c), (d) and (e)

Rainfall data

Design rainfall depth (days)	5						See Sections 6.3.4 (d) and (e)
Design rainfall depth (percentile)	85						See Sections 6.3.4 (f) and (g)
x-day, y-percentile rainfall event	41						See Section 6.3.4 (h)
Rainfall intensity : 2-year, 6-hour storm	13						See IFD chart for the site

RUSLE Factors

Rainfall erosivity (R -factor)	3660						Automatic calculation from above data
Soil erodibility (K -factor)	0.019						RUSLE data can be obtained from Appendixes A, B and C
Slope length (m)	55						
Slope gradient (%)	3						
Length/gradient (LS -factor)	0.55						
Erosion control practice (P -factor)	1.3						
Ground cover (C -factor)	1						

Calculations

Soil loss (t/ha/yr)	50						
Soil Loss Class	1						See Section 4.4.2(b)
Soil loss (m ³ /ha/yr)	38						
Sediment basin storage volume, m ³	3						See Sections 6.3.4(i) and 6.3.5 (e)

© COPYRIGHT of this design and plan is the property of ACOR Consultants Pty Ltd. ACN 079 306 246 ABN 40 079 306 246, all rights reserved. It must not be used, modified, reproduced or copied wholly or in part without written permission from ACOR Consultants Pty Ltd.

This drawing has been assigned an electronic code that signifies the drawing has been checked and approved by:

C	ISSUE FOR DA	12.08.20	AA	TF
B	ISSUE FOR DA	10.08.20	AA	TF
A	ISSUE FOR DA	07.08.20	AA	TF
Issue	Description	Date	Drawn	Approved
<div><div></div><div>0</div><div>10m at full scale</div><div>100m</div><div>200m</div></div>				

Client
PATHWAYS PROPERTY GROUP

40 CHANDOS STREET
ST LEONARDS, NSW, 2065
PHONE : 1800 825 586

Architect
MORRISON DESIGN PARTNERSHIP ARCHITECTS

302/69 CHRISSTIE STREET
ST LEONARDS, NSW, 2065
PHONE : 9966 5566



ACOR Consultants Pty Ltd
Suite 2, Level 1, 33 Herbert Street
St Leonards NSW 2065
T +61 2 9438 5098



ENGINEERS | MANAGERS | INFRASTRUCTURE PLANNERS | DEVELOPMENT CONSULTANTS

Project
LONGUEVILLE AGED CARE DEVELOPMENT

16 NORTHWOOD ROAD
NORTHWOOD, NSW, 2066

Drawing Title
SEDIMENT BASIN CALCULATIONS

Drawn AA	Date AUG 20	Scale NTS	A1	Q.A. Check Q.A.	Date Q.A. DATE
Designed AA	Project No. NSW200613	Dwg. No. DAC8.01		Issue C	

DRAWING UNDER REVISION

NOT FOR CONSTRUCTION

S:\2020\200613\200613.dwg
Aug 20, 2020 : 1:35pm